

# Soft Recovery Diode

## Types M0759Y#040 to M0759Y#160

The data sheet on the subsequent pages of this document is a scanned copy of existing data for this product.

(Rating Report 83NR8 Issue 2)

This data reflects the old part number for this product which is: **SM02-16CXC190**.  
This part number must **NOT** be used for ordering purposes – please use the ordering particulars detailed below.

The limitations of this data are as follows:  
Device no longer available for grade 02 (200V  $V_{RRM}$ )  
Only 'C' outline drawing (W2) in datasheet

The following links will direct you to the appropriate outline drawings  
Outline W2 – Standard 14.5mm clamp height capsule  
Outline W3 – 26mm clamp height capsule

Where any information on the product matrix page differs from that in the following data, the product matrix must be considered correct

An electronic data sheet for this product is presently in preparation.

For further information on this product, please contact your local ASM or distributor.

Alternatively, please contact Westcode as detailed below.

<b>Ordering Particulars</b>			
M0759	Y#	◆◆	0
Fixed Type Code	YC – 14.5mm clamp height YH – 26mm clamp height	Voltage code $V_{RRM}/100$ 04-16	Fixed Code
Typical Order Code: M0759YC120, 14.5mm clamp height, 1200V $V_{RRM}$			

**IXYS Semiconductor GmbH**  
Edisonstraße 15  
D-68623 Lampertheim  
Tel: +49 6206 503-0  
Fax: +49 6206 503-627  
E-mail: [marcom@ixys.de](mailto:marcom@ixys.de)

# WESTCODE

An IXYS Company

**Westcode Semiconductors Ltd**  
Langley Park Way, Langley Park,  
Chippenham, Wiltshire, SN15 1GE.  
Tel: +44 (0)1249 444524  
Fax: +44 (0)1249 659448  
E-mail: [WSL.sales@westcode.com](mailto:WSL.sales@westcode.com)

**IXYS Corporation**  
3540 Bassett Street  
Santa Clara CA 95054 USA  
Tel: +1 (408) 982 0700  
Fax: +1 (408) 496 0670  
E-mail: [sales@ixys.net](mailto:sales@ixys.net)

[www.westcode.com](http://www.westcode.com)

[www.ixys.com](http://www.ixys.com)

**Westcode Semiconductors Inc**  
3270 Cherry Avenue  
Long Beach CA 90807 USA  
Tel: +1 (562) 595 6971  
Fax: +1 (562) 595 8182  
E-mail: [WSI.sales@westcode.com](mailto:WSI.sales@westcode.com)

The information contained herein is confidential and is protected by Copyright. The information may not be used or disclosed except with the written permission of and in the manner permitted by the proprietors Westcode Semiconductors Ltd.

© Westcode Semiconductors Ltd.

In the interest of product improvement, Westcode reserves the right to change specifications at any time without prior notice.

Devices with a suffix code (2-letter, 3-letter or letter/digit/letter combination) added to their generic code are not necessarily subject to the conditions and limits contained in this report.

QUALITY EVALUATION LABORATORY

Rating Report: 83NR8 (Issue 2)

Date: 1st July, 1986

Origin:

Pages: 22

Diode Type SMO2-16CXC190

Written by:

*M. W. J. ...*

Checked:

*M.W.*

Approved:

*B.L.A.*

The CXC190 series of diffused fast recovery diodes is based on a 30 mm diameter slice housed in a cold weld capsule. Alternative ratings are included in this Report for use with either the single or double side cooling beam clamp (400Kg.f), or the single side cooling box clamp assembly (365Kg.f) in addition to the full pressure ratings up to 1000Kg.f. This Report supersedes Rating Report 83NR8 Issue 1.

Ratings

Voltage Grades	:	2-16
$V_{RSM}$	:	300-1700V
$V_{RRM}$	:	200-1600V
$I_F(AV)$ : Single phase, 50 Hz, 180° Sinewave )	:	
Double side cooled, $T_{HS} = 55^{\circ}C$ ; 100° )	Minimum	: 760A, 345A
Single side cooled, $T_{HS} = 100^{\circ}C$ )	mounting	
	force =	: 190A
	530Kg.f	
$I_F(rms)$ Double side cooled )		: 1,540A
$I_F(d.c)$ Double side cooled ) $T_{HS} = 25^{\circ}C$ )		: 1,245A
$I_F(AV)$ : Single phase, 50 Hz, 180° Sinewave )	:	
Double side cooled, $T_{HS} = 55^{\circ}C$ , 100° )	Minimum	: 645A, 286A
Single side cooled, $T_{HS} = 100^{\circ}C$ )	mounting	
	force =	: 165A
	365Kg.f	
$I_F(rms)$ Double side cooled, $T_{HS} = 25^{\circ}C$ )		: 1,310A
$I_F(d.c)$ Double side cooled, $T_{HS} = 25^{\circ}C$ )		: 1,050A
$I_{FSM}$ : t = 10ms half sinewave; $T_J$ (initial) = 125°;		
	$V_{RM} = 0.6V_{RRM(MAX)}$	: 9,500A
$I_{FSM}$ : t = 10ms half sinewave; $T_J$ (initial) = 125°;		
	$V_{RM} \leq 10V$	: 10,450A
$I^2t$ : t = 10ms; $T_J$ (initial) = 125°; $V_{RM} = 0.6V_{RRM(MAX)}$		: $0.45 \times 10^6 A^2 SECS$
$I^2t$ : t = 10ms; $T_J$ (initial) = 125°; $V_{RM} \leq 10V$		: $0.546 \times 10^6 A^2 SECS$
$I^2t$ : t = 3ms; $T_J$ (initial) = 125°; $V_{RM} \leq 10V$		: $0.404 \times 10^6 A^2 SECS$
$T_{HS}$ Operating range		: -40 to +125°
$T_{stg}$ : Non-operating		: -40 to +150°

Characteristics

(Maximum values unless stated otherwise)

$V_D$ : $T_J = 125^{\circ}\text{C}$	:	1.13V
$r_s$ : $T_J = 125^{\circ}\text{C}$	:	0.38mohms
$V_{FM}$ : $I_{FM} = 1500\text{A}$ $T_{VJ} = 125^{\circ}\text{C}$	:	1.7V
$R_{th}$ (J-HS) Double side cooled, mounting force (365-530Kg.f)	:	0.0625 $^{\circ}\text{C}/\text{W}$
(530-1000Kg.f)	:	0.05 $^{\circ}\text{C}/\text{W}$
Single side cooled, mounting force (365-530Kg.f)	:	0.125 $^{\circ}\text{C}/\text{W}$
(530-1000Kg.f)	:	0.1 $^{\circ}\text{C}/\text{W}$
$I_{RRM}$ : $T_J = 125^{\circ}\text{C}$ $V_{RM} = V_{RRM}(\text{MAX})$	:	50mA
$Q_{rr}$ : $I_{FM} = 550\text{A}$ ; $dI/dt = 40\text{A}/\mu\text{S}$	:	55 $\mu\text{C}$
$V_{RM} = 50\text{V}$ $T_{VJ} = 125^{\circ}\text{C}$	:	
$t_{rr}$ (conditions as above)	:	2 $\mu\text{S}$
Mounting force	:	365-1000Kg.f
Outline Drawing	:	100A291
JEDEC No.	:	DO200AA

CONTENTS

	<u>Page</u>
Ratings and Characteristics	1, 2
Voltage Grade Table	4
(2) <u>Introduction</u>	5
(3) <u>Notes on the Ratings</u>	
(a) Square-wave ratings	5
(b) Energy per pulse characteristics	5
(4) <u>Reverse Recovery Loss</u>	
(a) Determination by Measurement	5
(b) Design Method	6
Limit Forward Characteristic	7
Transient Thermal Impedance	8
Surge Rating	9
Recovered Charge	10
S. Factor	11
Reverse recovery energy per pulse	12
Square wave frequency rating 85 <sup>o</sup> C Sink 200A/uS	13
Square wave frequency rating 55 <sup>o</sup> C Sink 200A/uS	14
Square wave frequency rating 85 <sup>o</sup> C Sink 100A/uS	15
Square wave frequency rating 55 <sup>o</sup> C Sink 100A/uS	16
Energy per pulse 200A/uS	17
Energy per pulse 100A/uS	18
Sine wave frequency rating 85 <sup>o</sup> C Sink	19
Sine wave frequency rating 55 <sup>o</sup> C Sink	20
Sine wave energy per pulse	21
Outline drawing	22

CHANGES TO RATING REPORT 83NR8

Page 12  $E_r$  v dI/dt curve redrawn

Page 13 Omitted.

Pages 1, 4 Voltage grades revised

Voltage Ratings

Voltage Class	$V_{RRM}$ V	$V_{RSM}$ V
02	200	300
04	400	500
06	600	700
08	800	900
10	1000	1100
12	1200	1300
14	1400	1500
15	1500	1600
16	1600	1700

This Report is applicable to higher or lower voltage grades when supply has been agreed by Sales/Production.

## 2.0 INTRODUCTION

The diode series comprises fast recovery cold-weld capsules with all diffused silicon slices. All these diodes have controlled reverse recovery characteristics with good "S" factors.

## 3.0 NOTES ON THE RATINGS

### (a) Square wave ratings

These ratings are given for leading edge linear rates of rise of forward current of 100 and 200A/uS.

### (b) Energy per pulse characteristics

These curves enable rapid estimation of device dissipation to be obtained for conditions not covered by the frequency ratings.

Let:  $E_p$  be the Energy per pulse for a given current and pulse width, in joules.

Then  $W_{AV} = E_p \times f$ .

and  $T_{SINK} = T_{J(MAX)} - W_{AV} R_{th}$

## 4.0 REVERSE RECOVERY LOSS

On account of the number of circuit variables affecting reverse recovery voltage, no allowance for reverse recovery loss has been made in these ratings. The following procedure is recommended for use where it is necessary to include reverse recovery loss.

### (a) Determination by Measurement

From waveforms of recovery current obtained from a high frequency shunt (see Note 1) and reverse voltage present during recovery, an instantaneous reverse recovery loss waveform must be constructed. Let the area under this waveform be  $A$  joules per pulse. A new heat sink temperature can then be evaluated from:

$$T_{SINK} \text{ (new)} = T_{SINK} \text{ (original)} - A \left( \frac{r_t \cdot 10^6}{t} + R_{th} \times f \right)$$

$$\text{where } r_t = 1.13 \times 10^{-4} \sqrt{t}$$

$t$  = duration of reverse recovery loss per pulse in microseconds

$A$  = Area under reverse loss waveform per pulse in joules (W.S.)

$f$  = rated frequency at the original heat sink temperature

The total dissipation is now given by

$$W_{(TOT)} = W_{(original)} + A \times f$$

NOTE 1

REVERSE RECOVERY LOSS BY MEASUREMENT

This device has a low reverse recovered charge and peak reverse recovery current. When measuring the charge care must be taken to ensure that:

- (a) a.c. coupled devices such as current transformers are not affected by prior passage of high amplitude forward current.
- (b) The measuring oscilloscope has adequate dynamic range - typically 100 screen heights - to cope with the initial forward current without overload.
- (c) Measurement of reverse recovery voltage waveform should be carried out with an appropriate snubber of 0.1uF and 5 ohms in series connected across diode anode to cathode.

(b) Design Method

In circumstances where it is not possible to measure voltage and current conditions, or for design purposes, the additional losses may be estimated from curves on page 12.

Let E be the value of energy per reverse cycle in joules (curves on page 12)

Let f be the operating frequency in Hz

$$\text{Then } T_{\text{SINK}}^{(\text{new})} = T_{\text{SINK}}^{(\text{original})} - E \times R_{\text{th}} \times f$$

Where  $T_{\text{SINK}}^{\text{new}}$  is the required maximum heat sink temperature and  $T_{\text{SINK}}^{\text{original}}$  is the heat sink temperature given with the frequency ratings.

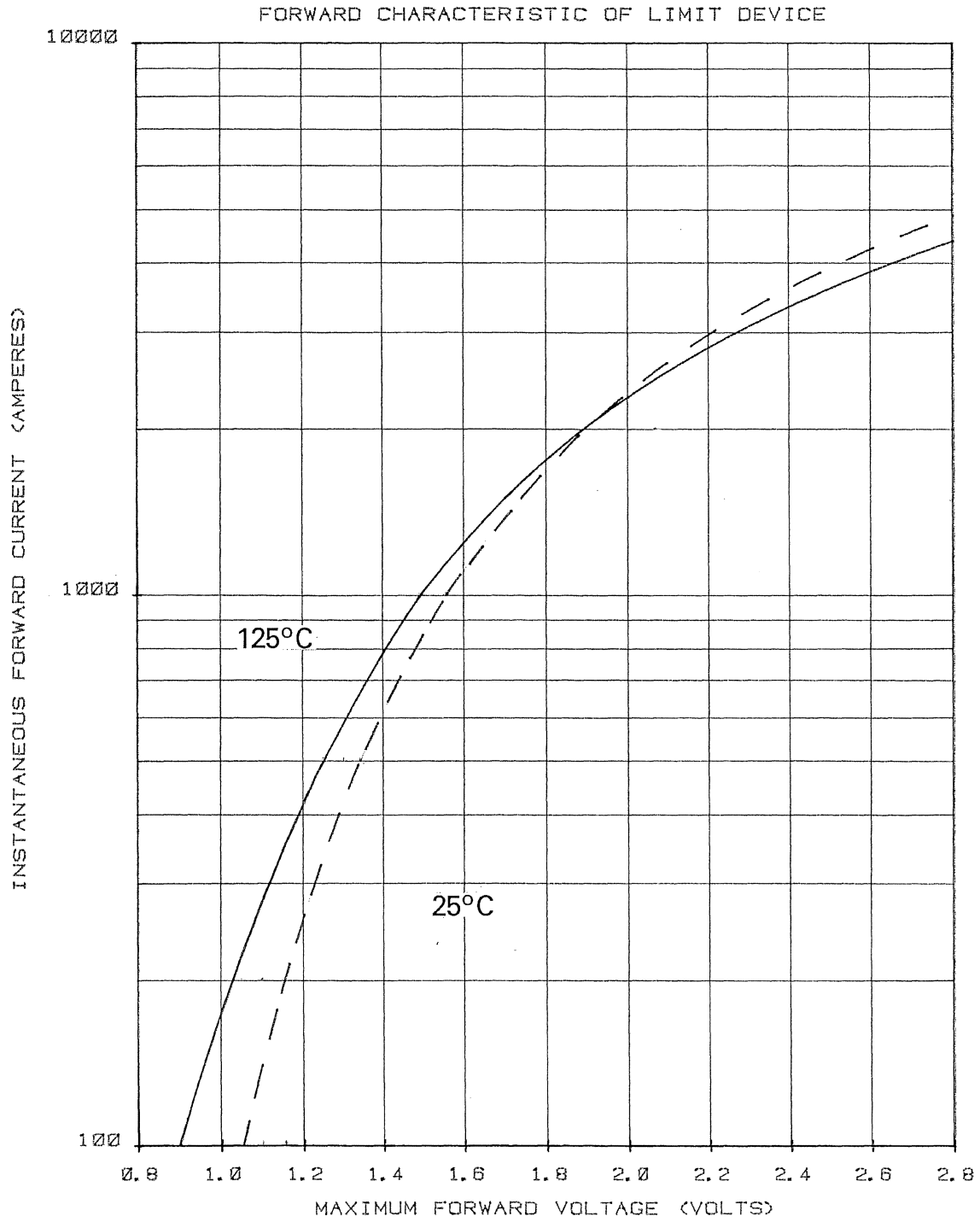



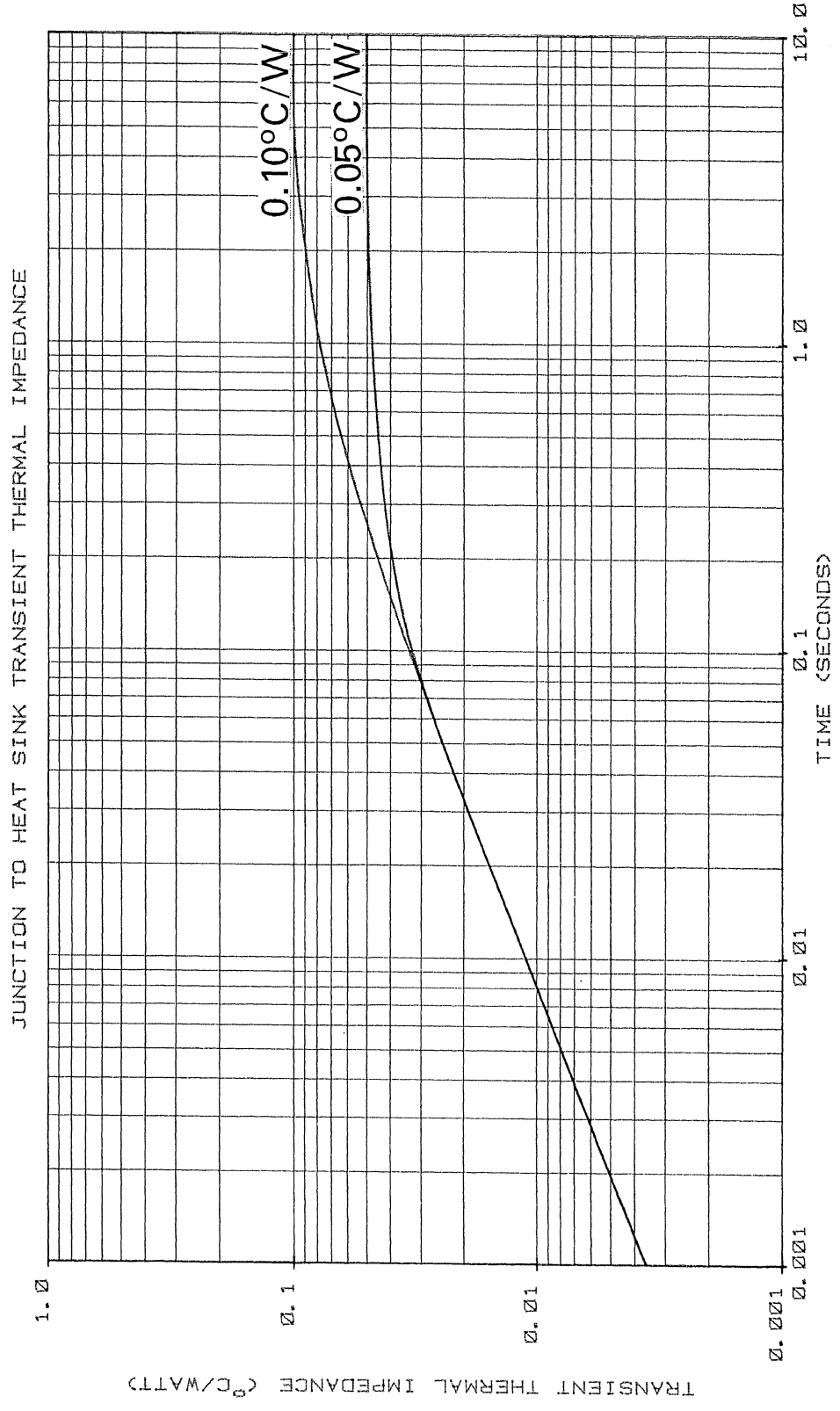

MAXIMUM NON REPETITIVE SURGE CURRENT AT INITIAL JUNCTION TEMPERATURE 125°C

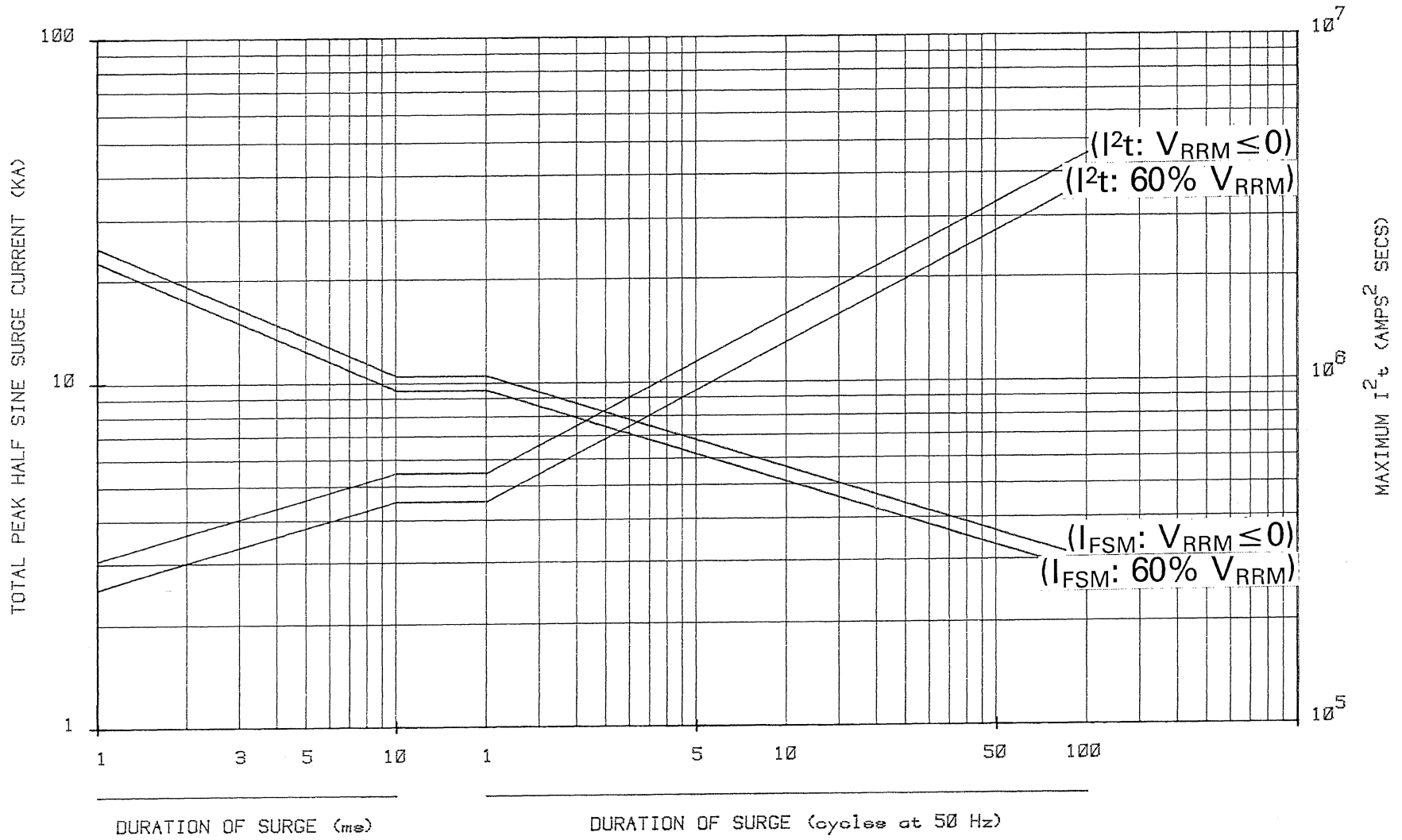

MAXIMUM RECOVERED CHARGE AT 125°C JUNCTION TEMPERATURE

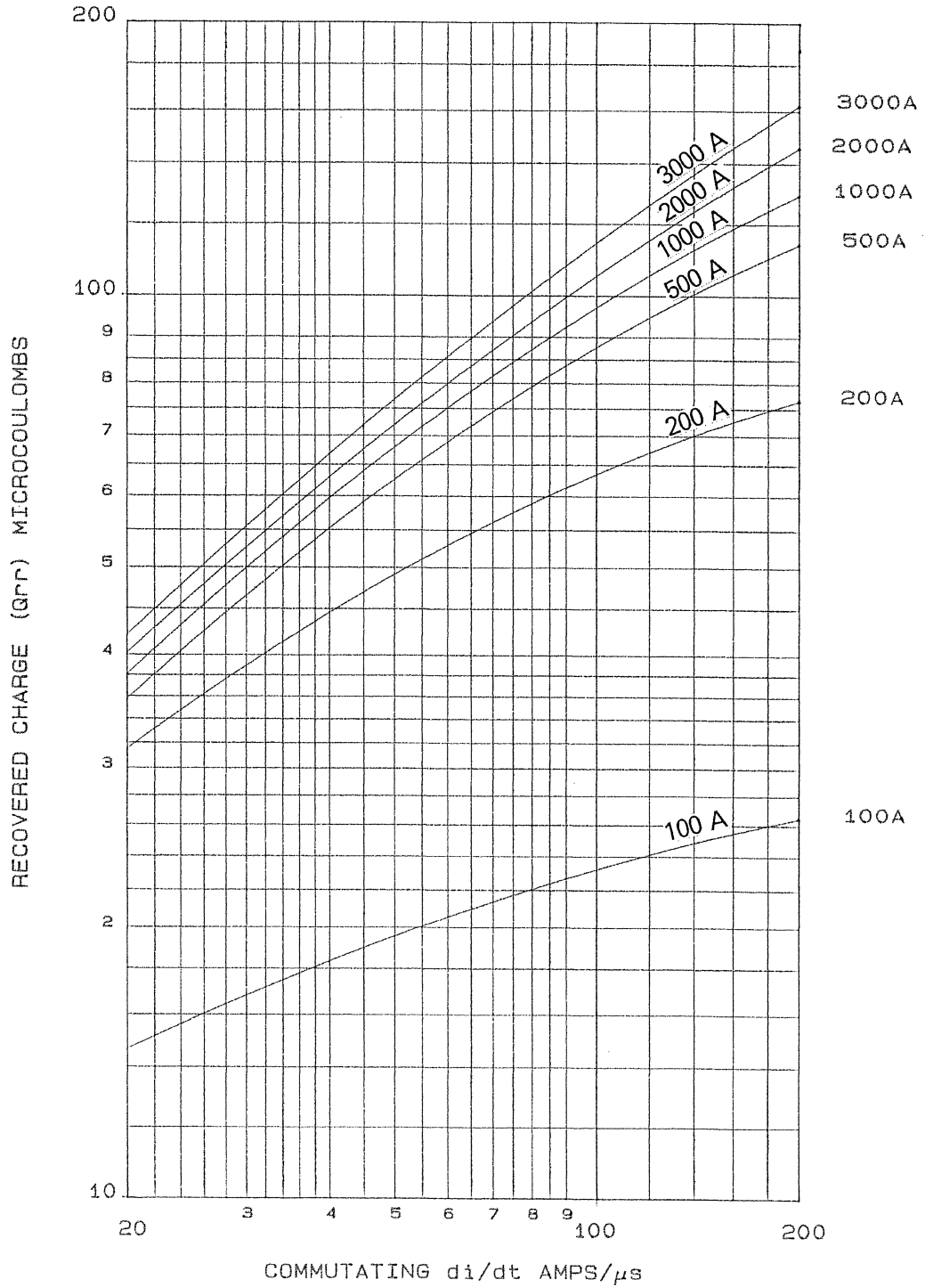

MINIMUM S FACTOR AT 125°C JUNCTION TEMPERATURE

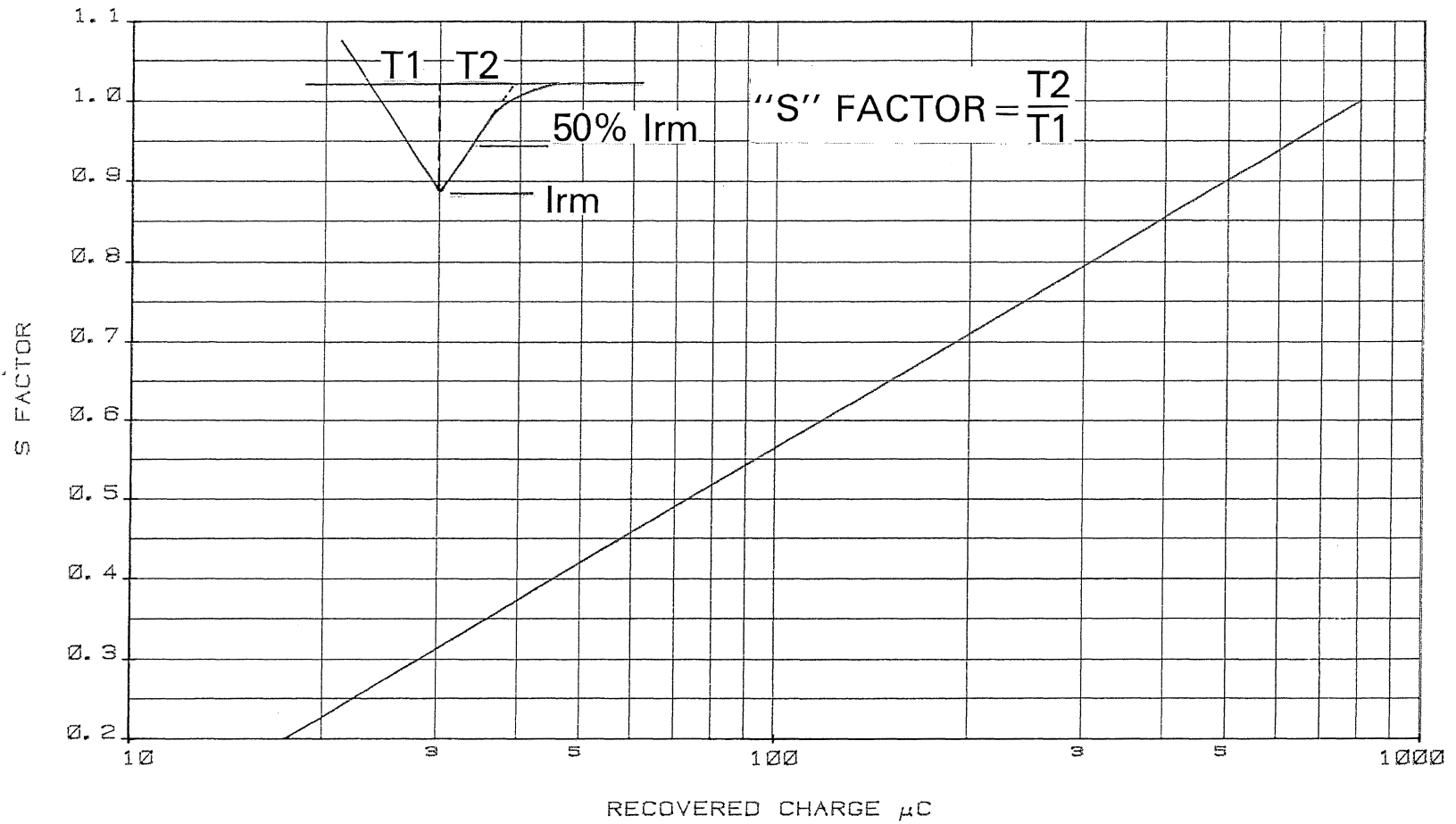

MAXIMUM REVERSE RECOVERY ENERGY LOSS PER PULSE, 125°C JUNCTION TEMPERATURE

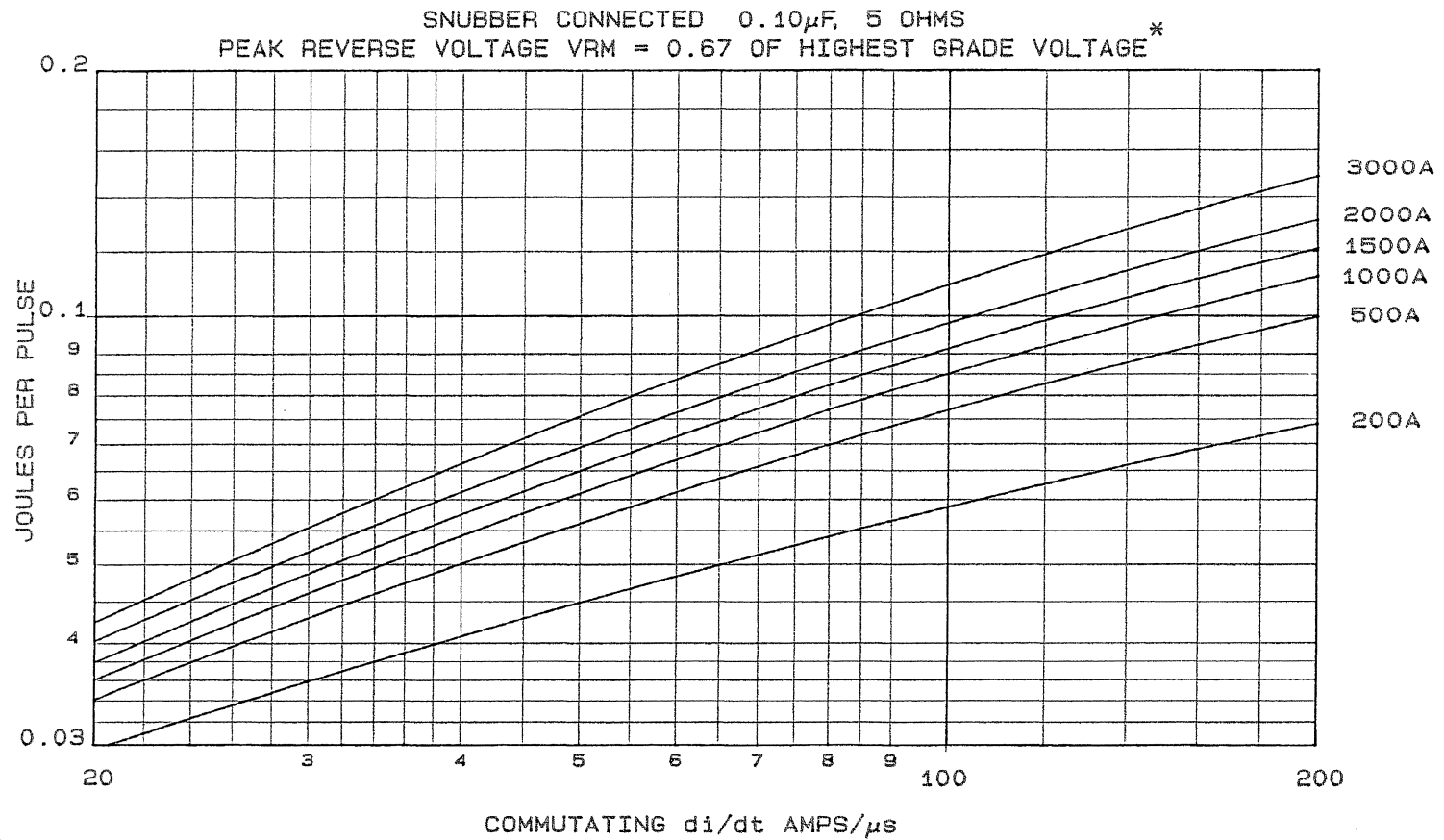

\* NOTE: ENERGY PER PULSE SHOULD BE ADJUSTED PRO RATA WITH APPLIED PEAK RECOVERY VOLTAGE

T SINK 85°C. 200A/μs

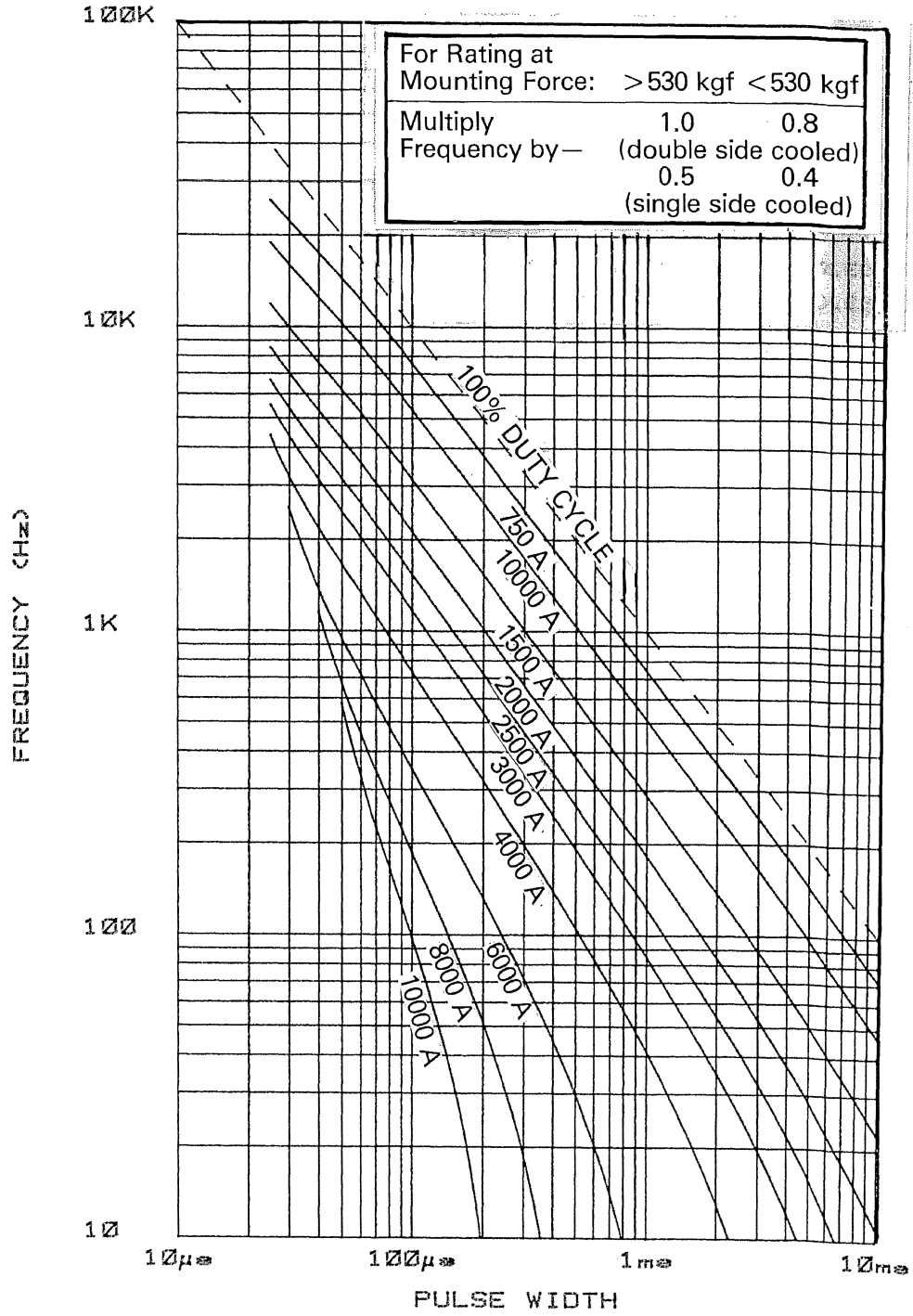

T SINK 85°C. 100A/μs

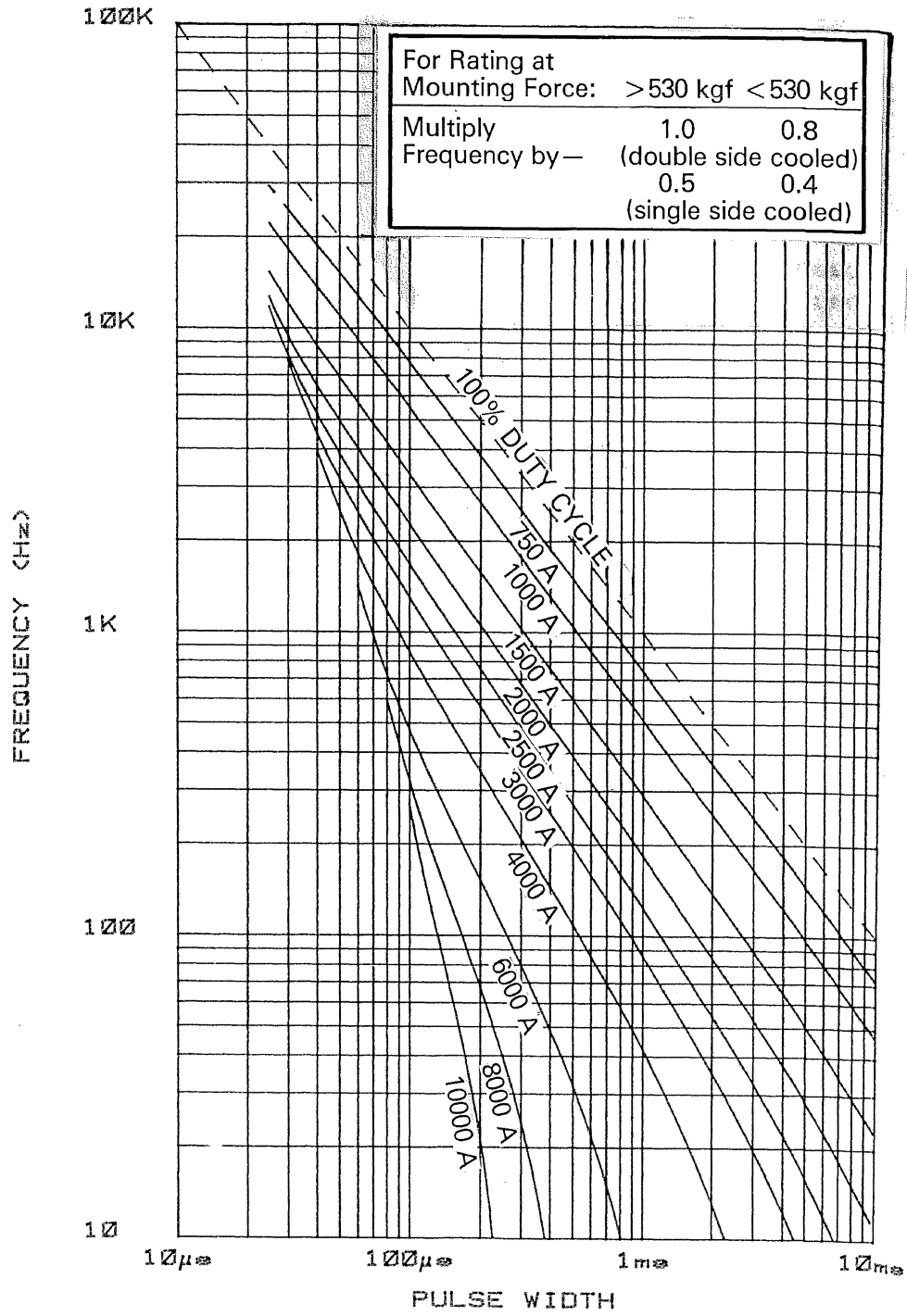

T SINK 55°C. 200A/μs

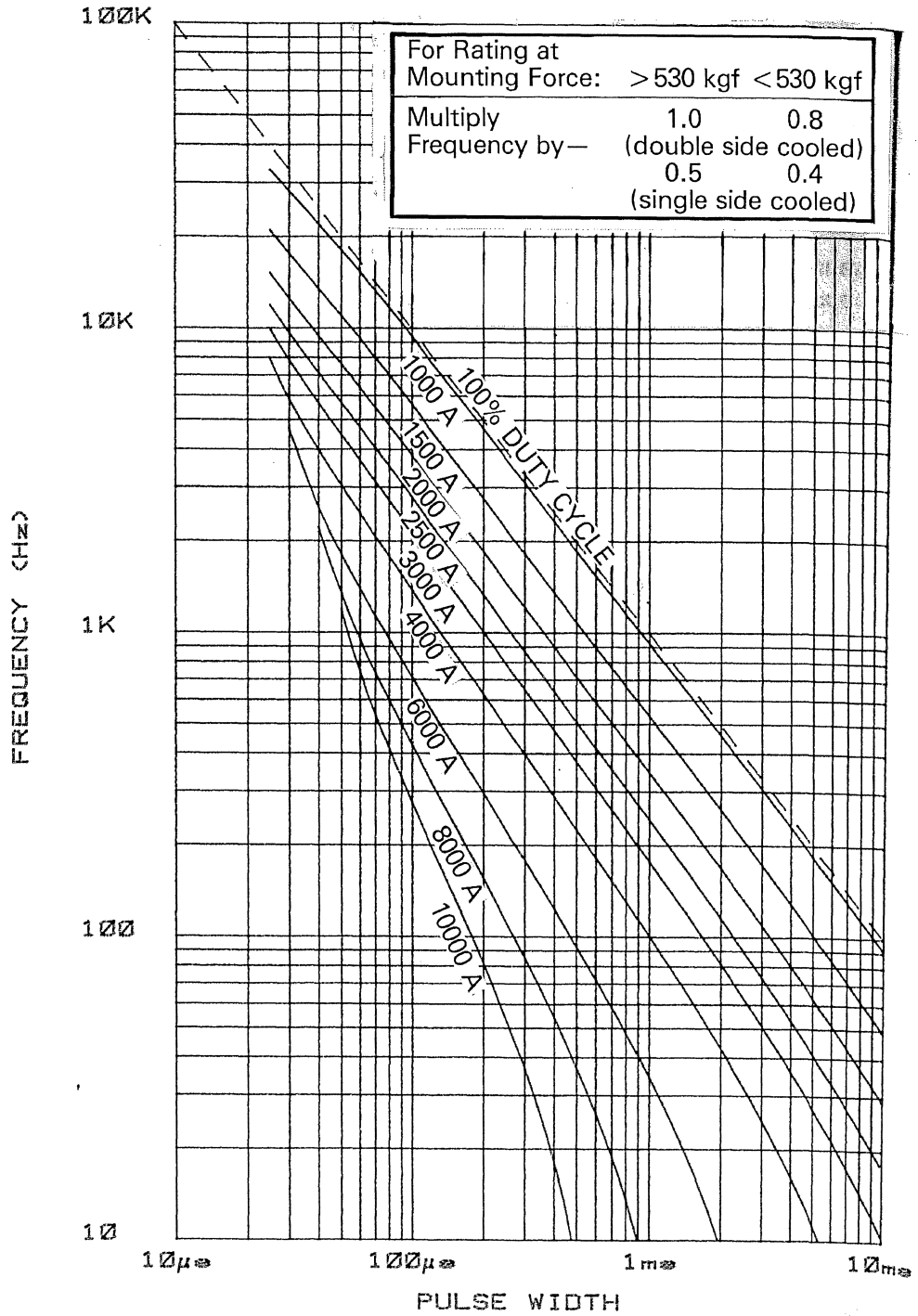



T SINK 55°C. 100A/μs

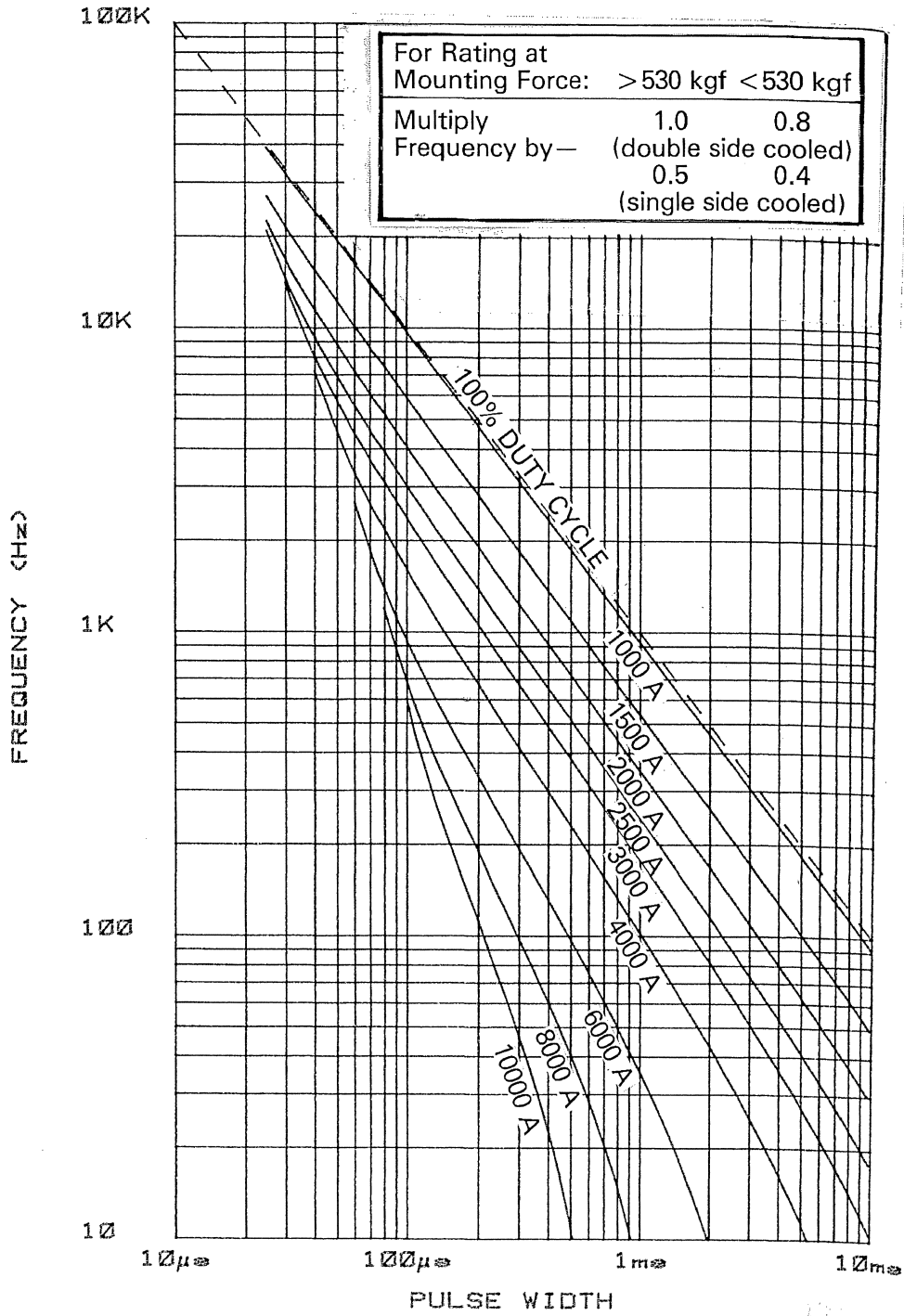

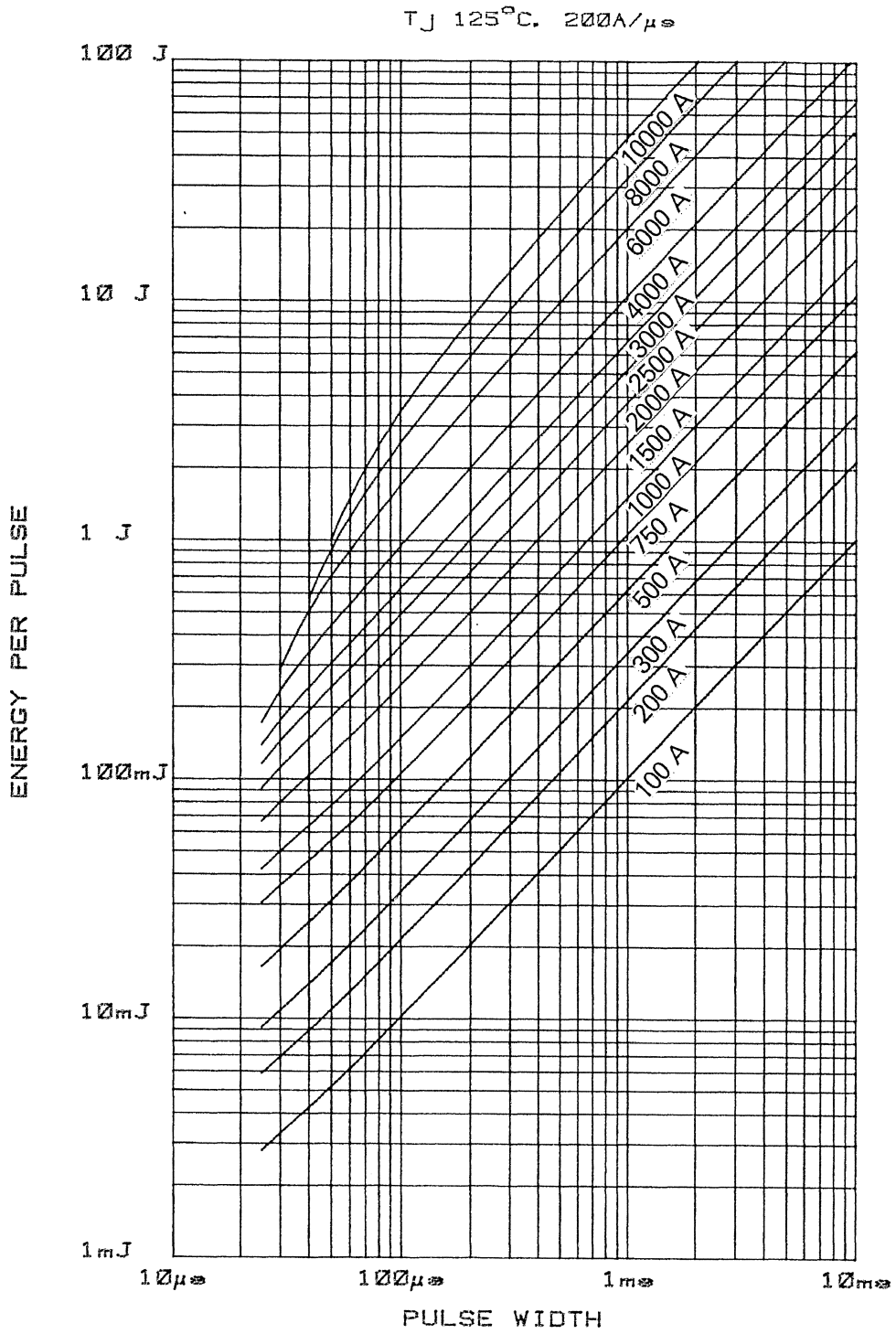

T<sub>J</sub> 125°C. 100A/μs

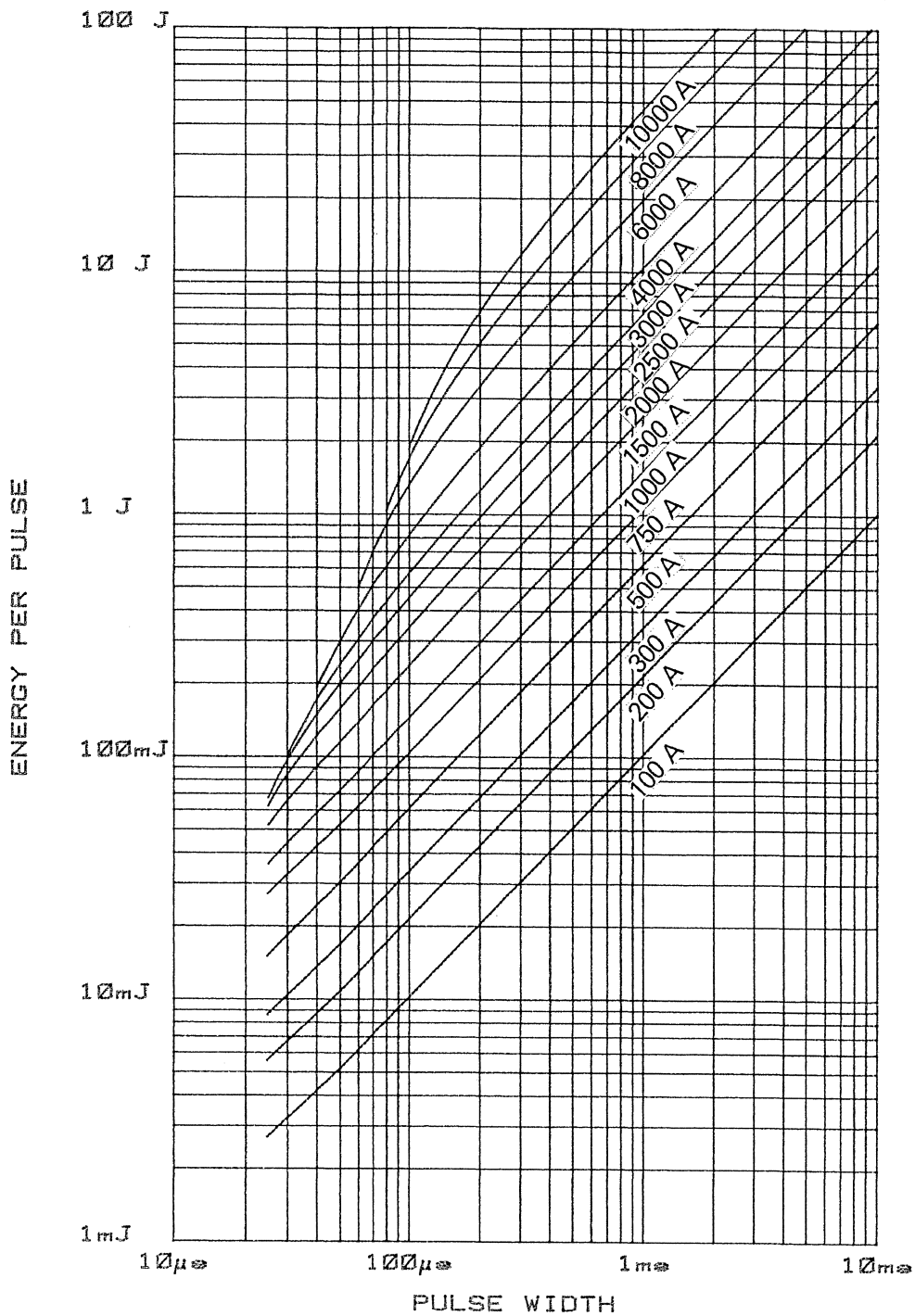

T SINK 85°C. SINE WAVE

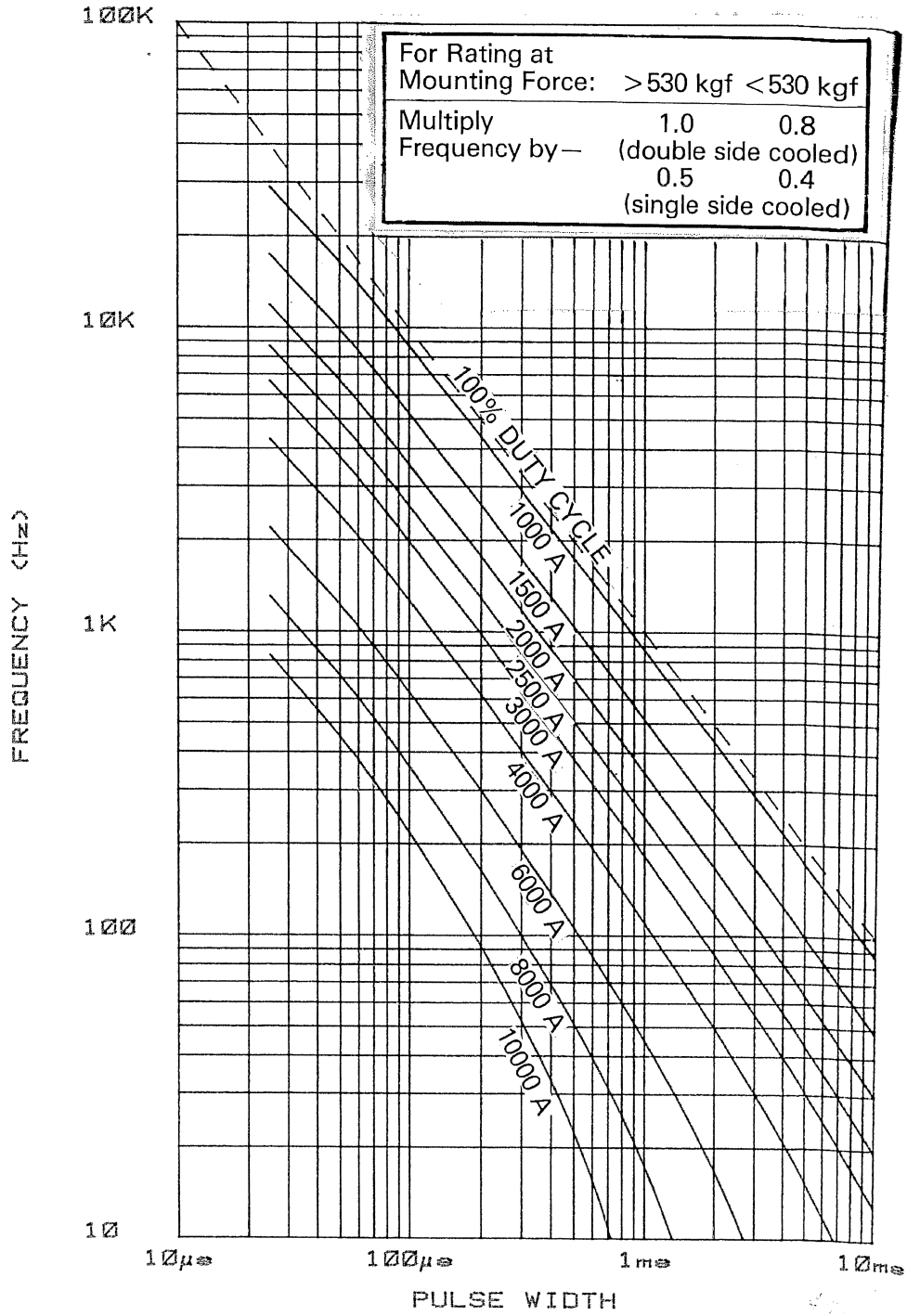

T SINK 55°C. SINE WAVE

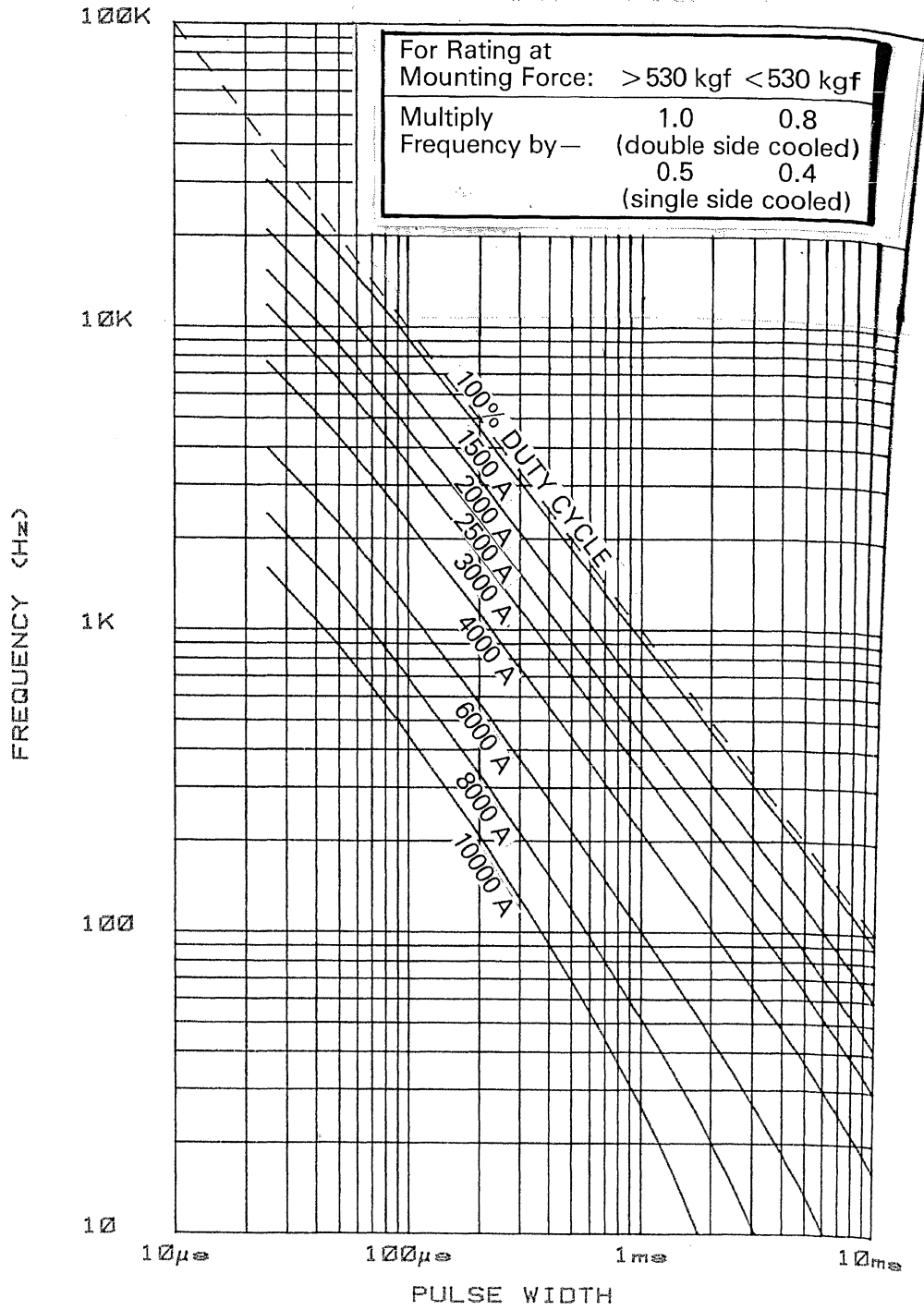

T<sub>J</sub> 125°C. SINE WAVE

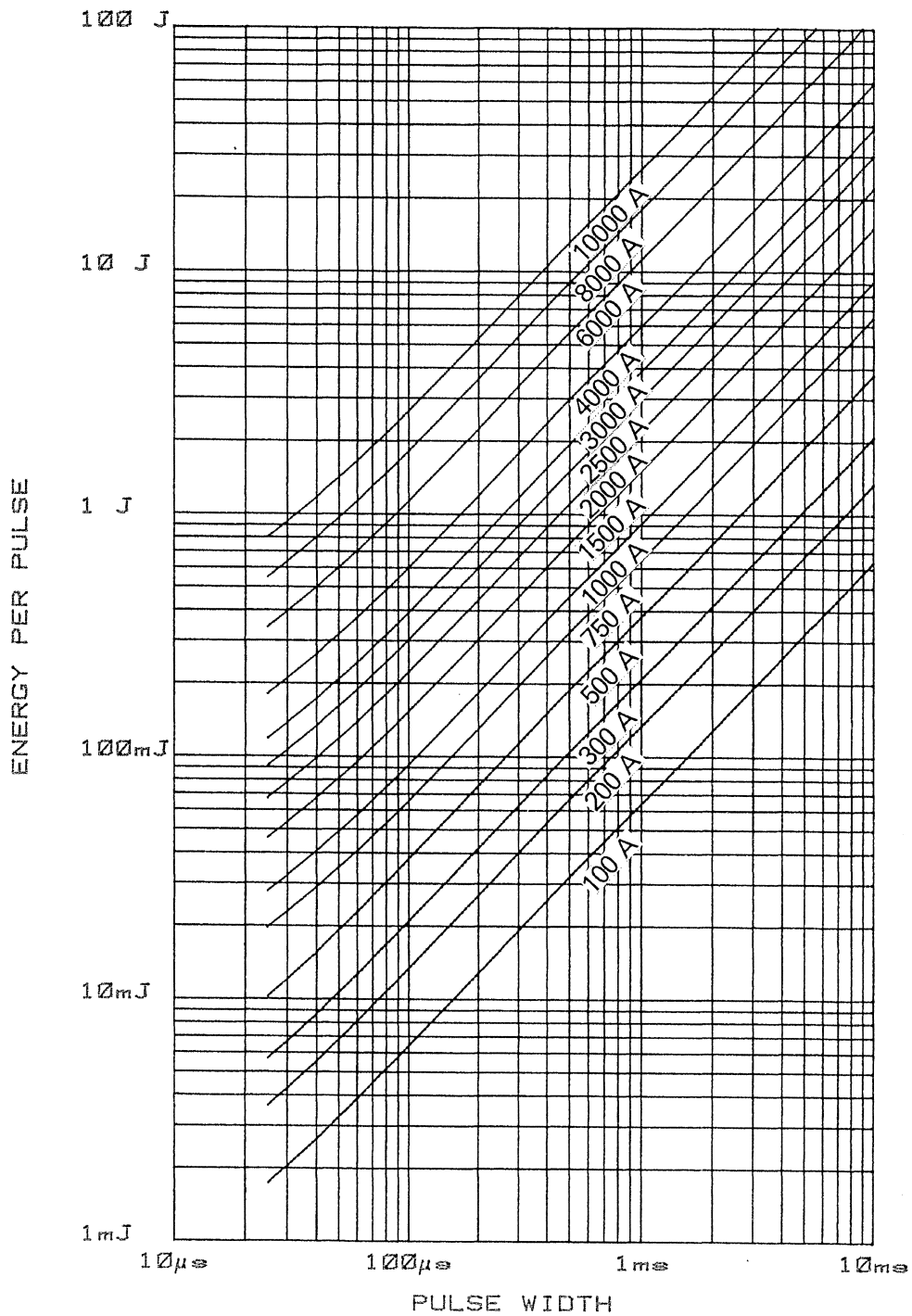

SCALE	1/1
DRN	105
CHKD	105
APPD	
A	
S	NI

INTERNATIONAL OUTLINE No. **DO-200AA**  
 WEIGHT. **90 GRAMS.**  
 FINISH. **NICKEL PLATE.**  
 DEVICE MARKING INCLUDES MONOGRAM, TYPE No., SPEC. No. AND POLARITY SYMBOL.  
 DEVICE MOUNTING: CLAMPING FORCE TO BE APPLIED ON  $\phi$  OF LOCATION HOLES AND BE EVENLY DISTRIBUTED OVER AREA OF CONTACT. FLAT TOL ON SURFACES TO WHICH DEVICE IS CLAMPED TO BE 0.04 WIDE.  
 CLAMPING FORCE 365 - 530 kgf. } SEE RATING REPORTS FOR DOUBLE  
 530 - 1000 kgf. } TIER THERMAL RESISTANCE RATINGS.  
 SUITABLE CLAMPS: BOX TYPE 101A226B, POWER CLAMP 101A260 SERIES.  
 G.A. DRG. No. **159B100H124**

TYPE NUMBER  
**CXC190**

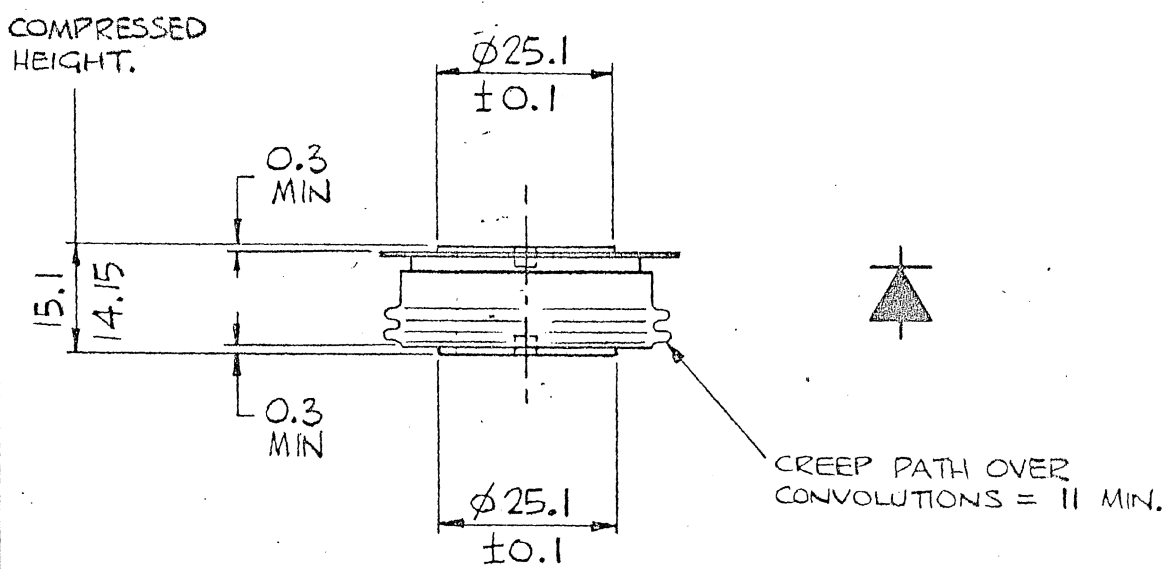
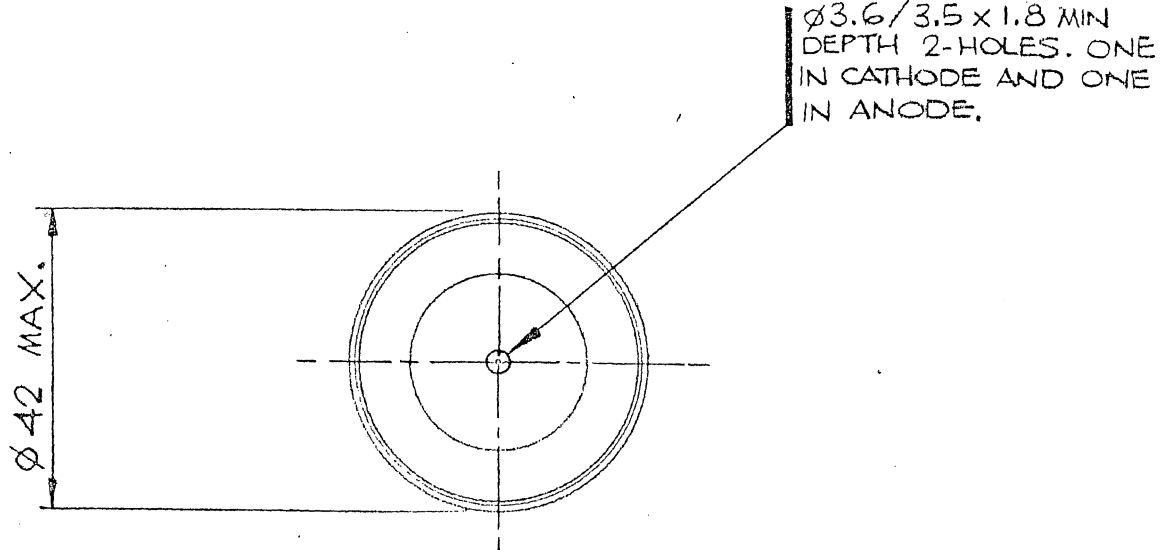

DRAWING IS SUPPLIED IN CONFIDENCE AND IS PROTECTED BY COPYRIGHT. THE INFORMATION MAY NOT BE DISCLOSED EXCEPT WITH THE WRITTEN PERMISSION OF AND IN MANNER PERMITTED BY, THE PROPRIETORS, WESTINGHOUSE BRAKE AND SIGNAL CO. LTD.

WESTINGHOUSE BRAKE AND SIGNAL CO. LTD.  
 CHIPPENHAM, WILTSHIRE, SN15 1JD, ENGLAND.

WESTCODE<sup>®</sup>  
 SEMICONDUCTORS

ISS	REVISIONS
1	6.3.80 P351
2	15.9.83 M1177 MTC & LOAD DETAILS & CLAMP DETAILS ADDED. <i>105</i>

THIRD ANGLE PROJECTION

DIMNS. IN MILLIMETRES

DRG. No. 10000001

Drawing Number – W2  
Outline Number – 100A291

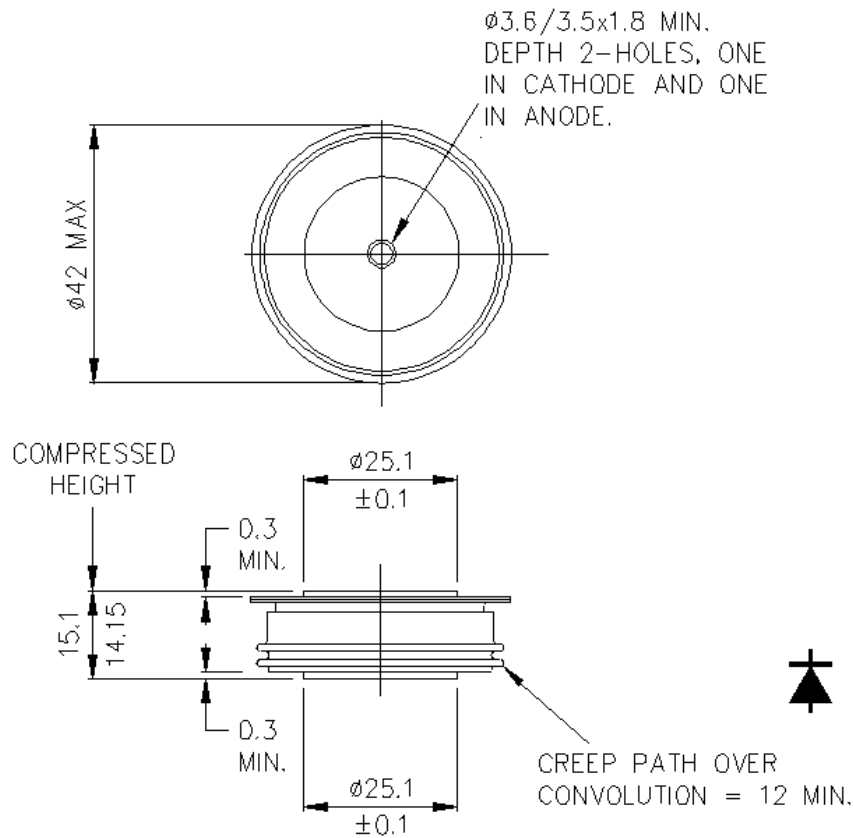

Weight 80g



**Drawing Number – W3**  
**Outline Number – 100A317**

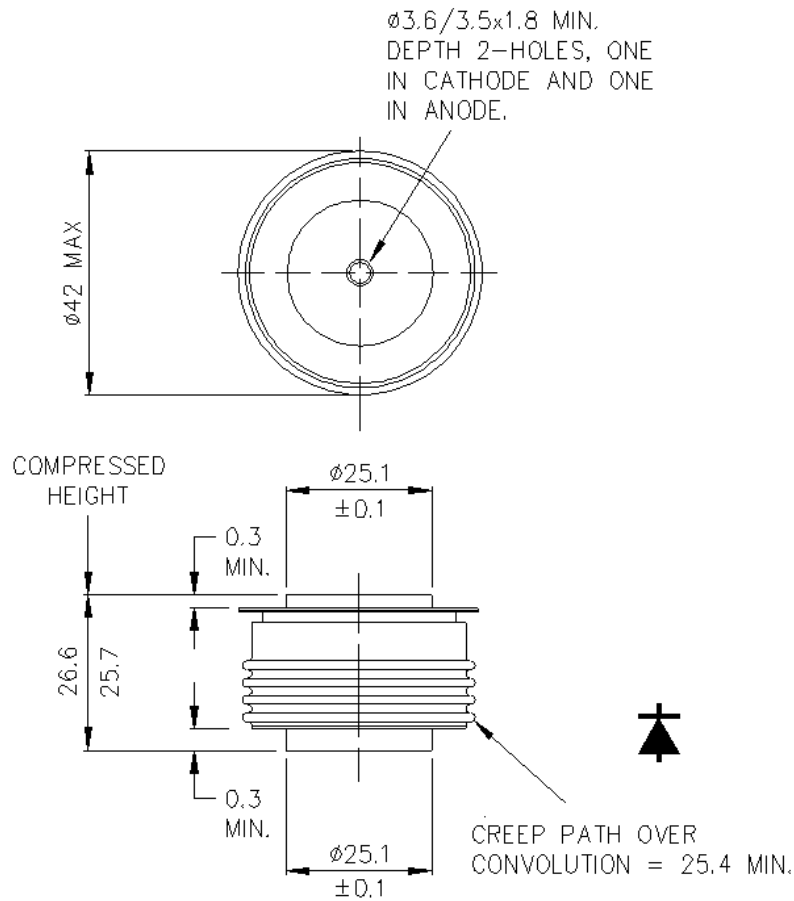

**Weight 140g**